



NEW MOTOR (LH/RH) & ENCODER INSTALLATION INSTRUCTIONS Q7ME



Please read these instructions carefully before beginning the installation. Failure to understand and follow installation instructions may result in injury to installer and/or end user and may void the warranty. If you have any questions call Sunrise Medical Technical support at 800-333-4000.

Required parts:

1. 2 ea Suretrac Enabled Motors (1LH, 1RH)
2. 1 ea RNet Encoder Module
3. 1 ea 12" RNet BUS Cable
4. 2 ea M5 screw & M5 washer

Tools required:

1. 16mm Socket
2. 10mm Socket
3. 5mm Hex key

A. REMOVE EXISTING MOTORS: 1 2 3 4

1. Power off the wheelchair.
2. Use the 5mm hex key to remove the screws (1) holding the rear shroud to the back of the chair, Fig 1.
3. Use the 5mm hex key to remove the screws (2) holding the controller and the controller mounting plate, Fig 1. Note- your controller may look different from the one shown.
4. Disconnect the cables coming from each motor from connection points M1 and M2 on the controller. Remove the cable from the wire saddles going from the controller to the motor. Figures 2 and 3.
5. Use a 16mm socket to remove the lug nuts (3) and the drive wheel, Fig 4.
6. Remove the 6 hex head cap screws (4) that attach the motor gearbox to the motor mount using a 10mm socket. Keep screws for later. Recycle old motors according to your local laws and regulations.
7. Repeat steps 5 and 6 on the opposite side of the wheelchair.

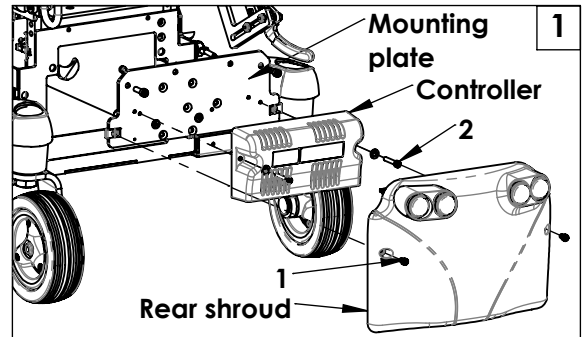

B. INSTALLING NEW MOTORS: 1 2 3 4 5

NOTE: IF CHANGING FROM MOTORS WITHOUT SURETRAC TO MOTORS WITH SURETRAC, PLEASE CONTACT SUNRISE MEDICAL TECH SERVICES. YOU WILL NEED A NEW PROGRAMMING FILE FOR SURETRAC TO FUNCTION PROPERLY.

1. Using the 6 hex head cap screws that were removed in Section A step 6, attach the new motor with Suretrac to the motor mount.
2. Use the wire saddles on the base, guide both the larger motor cable and the smaller Suretrac cable to the area where the controller mounts.
3. Remove the RNet bus cable that is connected to the controller, Fig 3. Connect the free end of the existing cable into the Encoder Module. Connect one end of the new RNet bus cable into the open bus port on the Encoder Module and the other into the bus port on the controller.

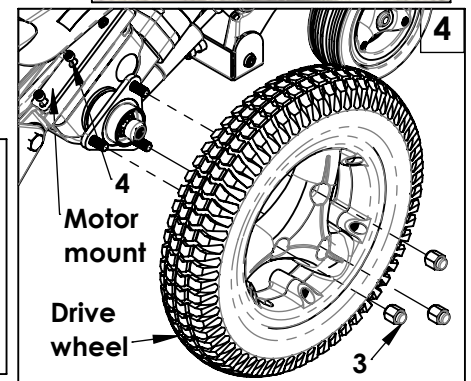
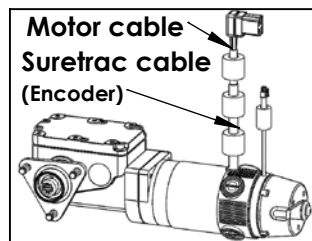
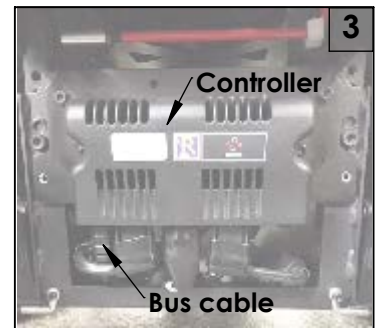
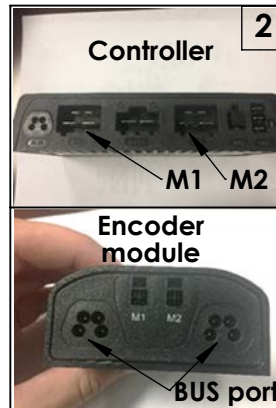

WARNING

4. WHEN CONNECTING THE MOTORS TO THE CONTROLLER AND THE ENCODER WIRE TO ENCODER MODULE, IT IS VERY IMPORTANT TO CONNECT THE PLUGS INTO THE CORRECT PORTS. THE LEFT MOTOR CONNECTS TO M1 ON THE CONTROLLER AND THE RIGHT MOTOR CONNECTS TO M2. IT IS IMPORTANT TO FOLLOW THIS SCHEME WHEN CONNECTING TO THE ENCODER MODULE.
5. After the connectors are in place, use the M5 screws and washers (5) to attach the encoder module to the mounting plate in the location shown, Fig 5. Torque to 2.3- 2.7 ft-lbs (3.1-3.7Nm).
6. Reinstall the drive wheel, controller plate and rear shroud, following steps 2, 3, 4, and 5 in Section A in the reverse order. Torque screws to 2.3- 2.7 ft-lbs (3.1-3.7Nm). Torque lug nuts to 25 ft-lbs (33.9Nm).

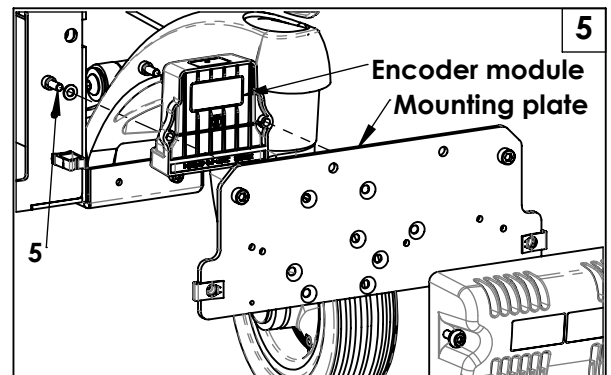

Sunrise Medical 2842 N. Business Park Ave Fresno, CA 93727 USA
In Canada (800) 263-3390



Customer service: 800.333.4000
or visit www.SunriseMedical.com

©2018 Sunrise Medical (US) LLC
05/18 248512 Rev. A