



Please read these instructions carefully before beginning the installation. Failure to understand and follow installation instructions may result in injury to installer and/or end user and may void the warranty. If you have any questions call Sunrise Medical Technical support at 800-333-4000.

Caster Lock parts:

1. 2 ea Caster Lock Mech. (L/R) (C)
2. 2 ea SHCS M8 x 20 screw (K)
3. 2 ea SHCS M8 x 22 screw (E)
4. 2 ea Nut Hex Thin M8 Black (F)

Tools needed for assembly:

1. 16mm socket wrench
2. Torque wrench
3. 13mm wrench
4. 6mm hex key

A. Caster Lock Removal:

1. Using a 16mm socket wrench, remove the drive wheels (A). Set wheels (A) and lug nuts (B) aside. (Fig. 1)
2. Follow the harnesses of each Caster Lock rearward (toward the back of the chair) and disconnect them from the chair harnesses for the Caster Locks. Both connectors should be near the rear corners of the battery weldment. (Fig. 2 & 3)
3. Now, with a 6mm hex key and a 13mm wrench, disconnect the front mounts for the Caster Locks. (Fig. 4) (E & F) Discard hardware.
4. With a 6mm hex key, remove the rear mounts for the Caster Locks. (Fig. 4) (K & H) Discard hardware. Remove both Caster Locks. If under warranty, return to Sunrise Medical, otherwise discard.

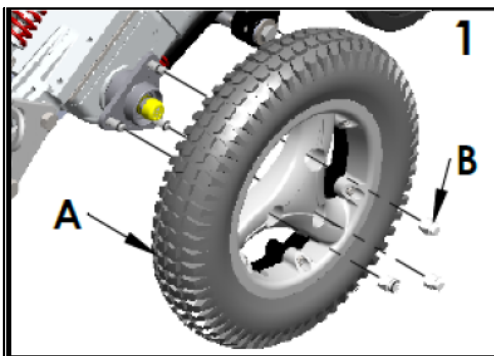

B. Caster Lock Installation:

1. Take screw (K) and place it through washer (H) and then through upper left hole of bracket (J). With a 6mm hex key, secure screw (K) into the threaded hole of the battery weldment, but do NOT tighten. (Fig. 4)
2. Take screw (E) and run it through the front mount hole of the Caster Lock and the hole of the front swing arm tab. Then take nut (F) and screw it onto screw (E). With a 6mm hex key and 13mm wrench, secure to the front swing arm tab. (Fig. 4) Torque to 120 - 132 in-lbs.
3. Go back to the rear mount from step 1 and torque screw (K) to 120 - 132 in-lbs.
4. Reconnect the Caster Lock harnesses to the chair harnesses that are located at the rear corner of the battery weldment. Both harnesses should be routed behind the motor mount shock and secured in the white clips along the side of the battery weldment. (Fig. 2 & 3)
5. With a 16mm socket wrench, re-attach the drive wheel. Torque to 25 ft/lbs.
6. Repeat steps 1-5 for the Caster Lock on the other side of the chair.

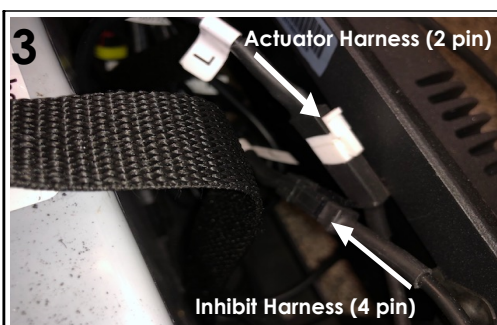

NOTE - Some parts (including drive motor) are not shown for clarity.

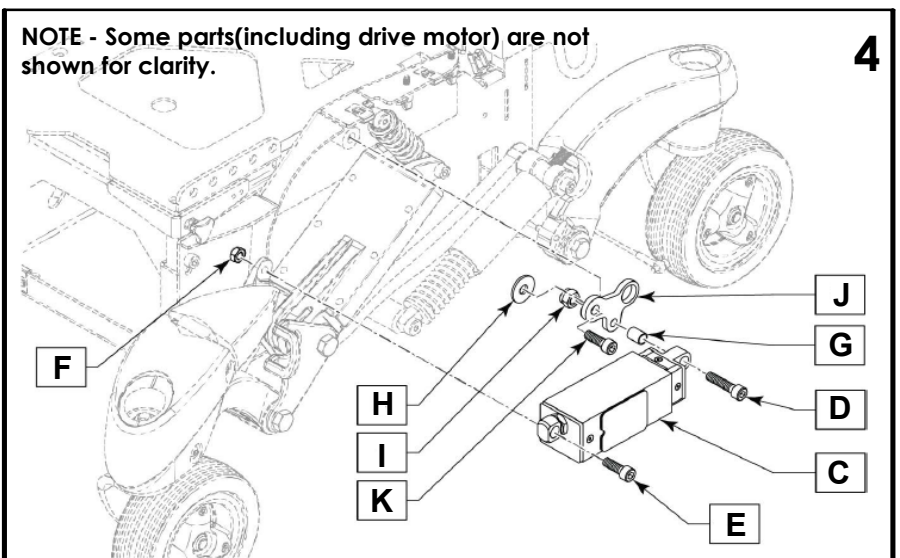

C. Harness Routing:

1. The Caster Lock system has two main harnesses that both run from the Caster Locks to the CXSM. (Fig. 5)
2. Each Caster Lock itself, has two harnesses(hard-wired) (Fig. 6) that go rearward on the chair, and connect to two main chair harnesses near the rear base of the chair.
3. The main inhibit harness connects with a 4 pin connector. (Fig. 7). The main actuator harness connects with a 2 pin connector. (Fig. 8)
4. From the 2 pin connectors and the 4 pin connectors, both the main actuator harness and the main inhibit harness lead over to the right rear corner of the battery weldment where it then joins the main spiral harnessing loom. (Fig. 9)
5. The main spiral harnessing then goes along the right side of the scissor mechanism on the seating module. (Fig. 10)
6. The harnessing loom continues to the front of the seating module and then leads rearward, just under the seat plates. (Fig. 11)
7. When the harnessing gets to the back of the seat area, it then joins into the main harnessing loom that leads up to the back of the chair. (Fig. 12)

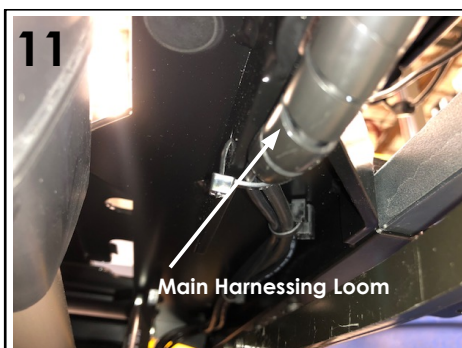
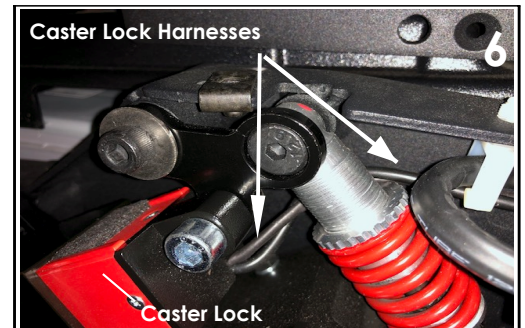
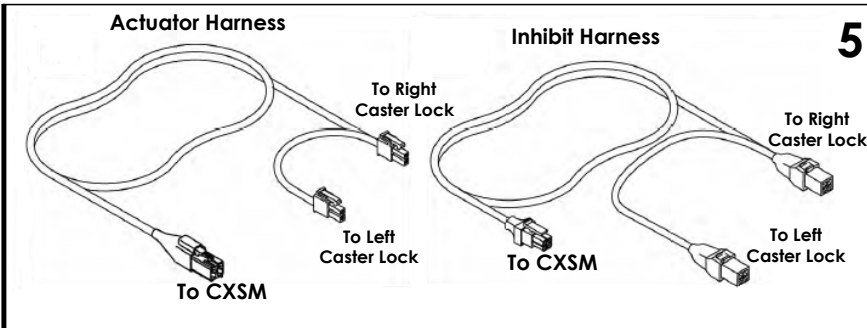

C. Harness Routing(continued):

8. Finally, the two main harnesses for the Caster Locks reach the CXSM box, located on the main upper back of the chair.
9. The main actuator harness plugs into actuator port 7 on the CXSM, which will be color coded in black. The main inhibit harness plugs into inhibit port 7 on the CXSM which will be marked with a "7". (Fig. 13)
10. Before securing down harnessing, check the system and make sure all harnessing is free from damage or areas where harnessing can get pinched. The test the system for proper operation before final securement.

D. INSPECT:

1. All torque values with a torque wrench.
2. Seating system to ensure all wire harnesses are out of the way and are not getting pinched.
3. Seating system to verify that the harnesses are not put under tension in any position.
4. Ensure that the cable-ties are not so tight that they deform cable jackets.
5. Where possible, cables should be protected and hidden by shrouds.

DEALER/TECHNICIAN WARNING**WARNING**

Attention dealers and qualified technicians, do not operate or service this device without first reading the owners manual. If you do not understand the instructions and warnings in the owners manual please contact the Quickie Technical Service Department before operating and/or servicing the Quickie device. Failure to do so may result in damage and/or injury.

Find more information and important warnings see the wheelchair owner's manual or at: www.SunriseMedical.com.

**Sunrise Medical 2842 Business Park Ave Fresno, CA 93727
In Canada (800) 263-3390**