

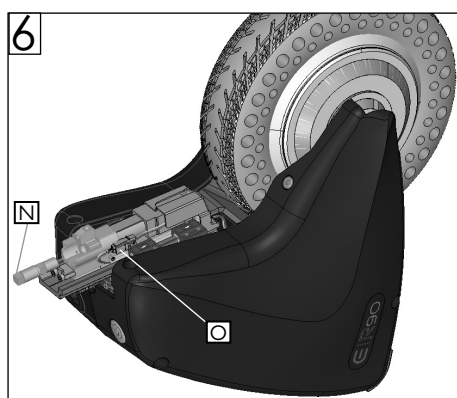

Please read these instructions carefully before beginning the assembly. Failure to understand and follow assembly instructions may result in injury to technician and/or end user and may void the warranty. If you have any questions call Sunrise Medical Technical Support at +1 (800) 333-4000.

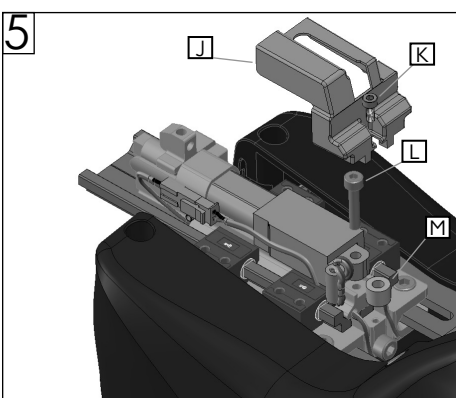
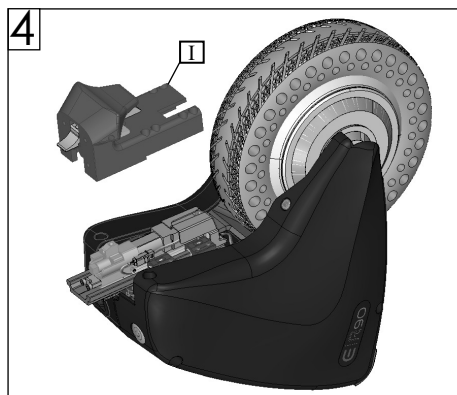
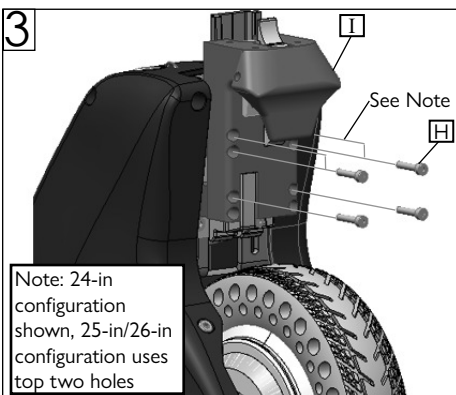
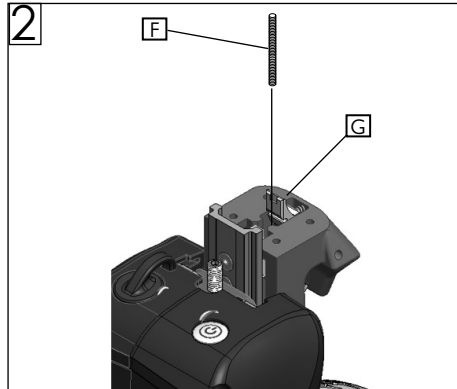
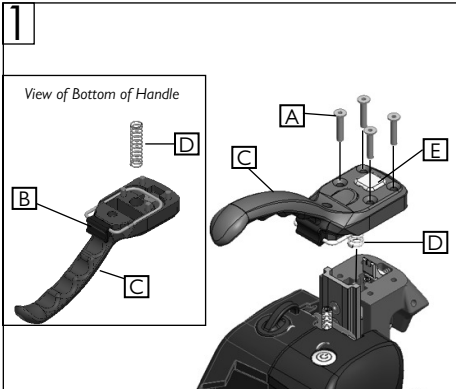

Tools required

1. Allen wrench, sizes: 1.5mm, 2.5mm, and 3mm

1. To remove handle: (Fig. 1)
 - a. Using a 3mm Allen wrench, unscrew the four screws (A) that hold the handle and the latch wire holder (B).
 - b. Remove hardware (A), handle (C), spring (D), and the latch button (E).
2. Remove the M4 set screw (F) using a 1.5mm Allen wrench. (Fig. 2)
Note: Hold latch (G) in order to get access to (F).
3. Using a 3mm Allen wrench, remove the front bolts (H) that mount the latch block (I). Note the position of the bolts for reassembly (Fig. 3)

To complete steps 4-11, set the device in a horizontal position.

4. Remove the latch block (I). (Fig. 4)
Note: There is a spring in the latch block. It must be positioned correctly for reassembly.
5. Next, remove the actuator.
 - a. Remove the cover bolt (K) and cover (J) using a 2.5mm Allen wrench. (Fig. 5)
 - b. Remove the bottom actuator bolt (L) using a 3mm Allen wrench. Next, remove the spacer underneath the actuator (M). (Fig. 5)
 - c. Back off the actuator bolt (N) by hand or with a plier. (Fig. 6)
 - d. Disconnect the connector (O) of the actuator harness. Then, remove the actuator. (Fig. 6)



DEALER/TECHNICIAN WARNING

Attention dealers and qualified technicians, do not operate or service this device without first reading the owners manual. If you do not understand the instructions and warnings in the owners manual please contact the Sunrise Medical Technical Service Department before operating and/or servicing the Empulse device. Failure to do so may result in damage and/or injury.

Find more information and important warnings in the device owner's manual or at: www.SunriseMedical.com.

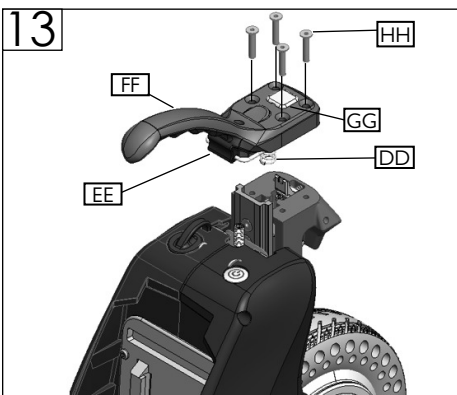
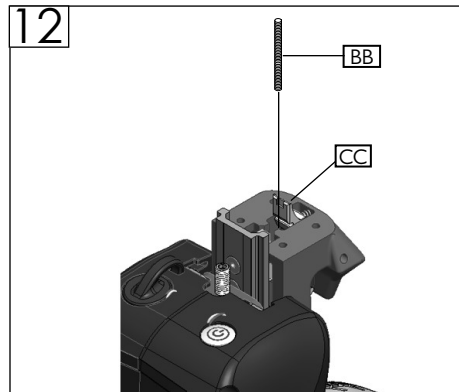
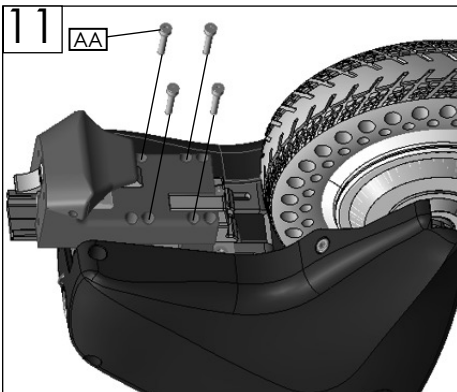
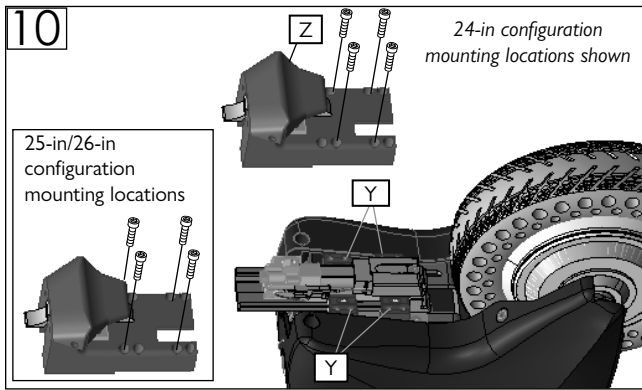
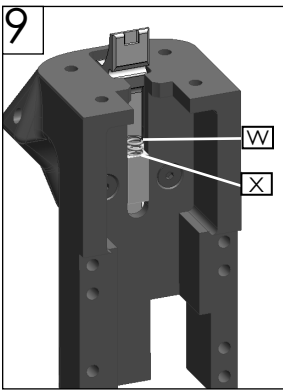
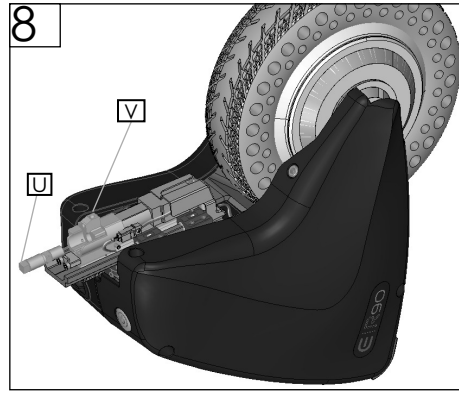
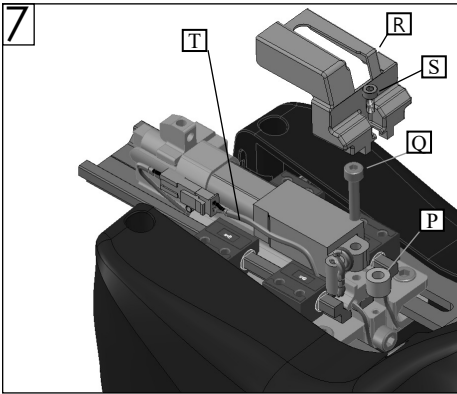

6. To mount the new actuator, follow step 5 in reverse order.
7. Attach the actuator bolt and cover:
 - a. First, ensure you insert the spacer (P) back under the actuator before inserting bolt (Q). Using a 3mm Allen wrench, fasten the M5 bolt (Q) and torque it to 2.2 Nm [1.7 ft-lbs]. Then, insert the cover (R) and torque M3 bolt (S) to 1.0 Nm [0.8 ft-lbs] using a 2.5mm Allen wrench. Ensure the wire (T) is not pinched. (Fig. 7)
 - b. Thread the actuator bolt (U) into the actuator through the insert (V) and tighten it completely. (Fig. 8)
8. Add Latch Block:
 - a. Ensure the spring (W) is still positioned in the pocket in the latch block (X). (Fig. 9)
 - b. Align the slider blocks (Y) with latch block (Z). (Fig. 10)
 - c. If the slider blocks are out of place, loosen the shroud a little.
 - d. Fasten the M5 hardware (AA) using a 3mm Allen wrench and torque to 2.2 Nm [1.7 ft-lbs]. (Fig. 11)
 Note: Refer to notes from step 3 for correct mounting position.
9. Insert M4 hardware (BB) in the latch block. (Fig. 12)
 Note: Hold latch (CC) in order to get access to (BB).
10. Place the spring (DD) into the actuator bolt. Then, hold the latch block (EE) on the handle (FF) and insert the handle into the latch block, insert the latch cover (GG), and torque the screws (HH) to 7.8 Nm [5.8 ft-lbs]. (Fig. 12)