



Please read these instructions carefully before beginning the assembly. Failure to understand and follow assembly instructions may result in injury to technician and/or end user and may void the warranty. If you have any questions call Sunrise Medical Technical Support at +1 (800) 333-4000.

Parts:

- | | |
|-----------------------------|------------------------------|
| 1. SEAT STAY (x1) | 3. E-CLIP (x1) |
| 2. FIR TREE CABLE CLIP (x1) | 4. 10G OF CYANOACRYLATE GLUE |

Required tools:

1. Flat Head Screw Driver
2. Needle Nose Pliers

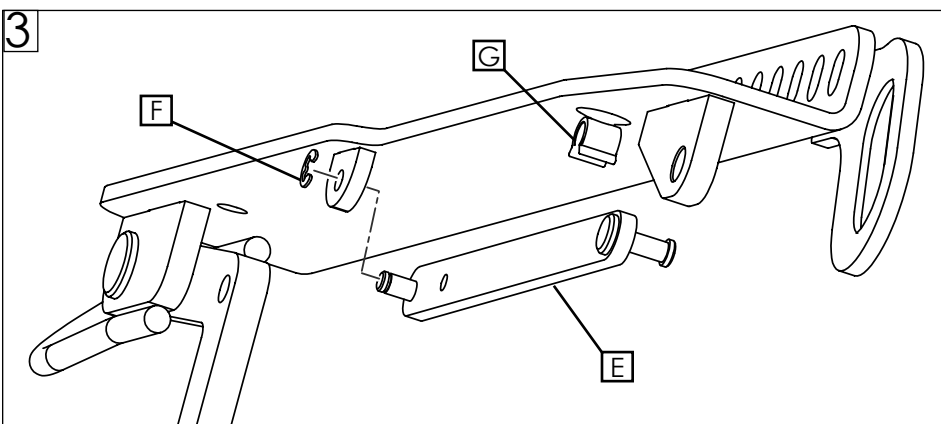
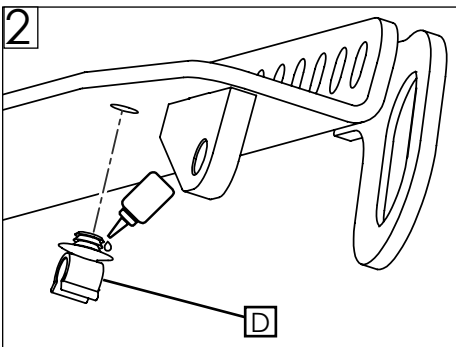
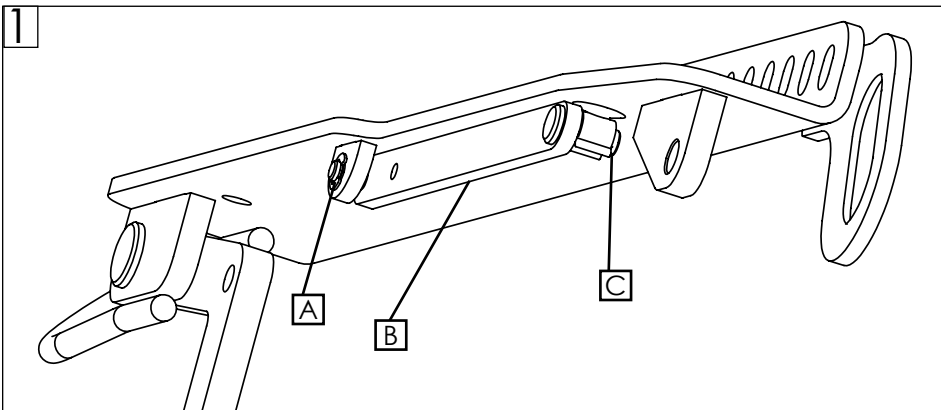

1. Using the flat head screw driver remove the old E-clip (A) and discard. Then, remove the old seat stay (B) and discard. (Fig 1)
2. Remove the old cable clip (C) and discard. (Fig 1)
3. Attach the new cable clip (D) on to the seat interface (Fig 2) and ensure you:
 - a. Put 2-3 drops of the glue on before putting it into the interface hole.
 - b. Attach the cable clip in the correct orientation to allow for the seat stay to clip into it.
 - c. Wait 5 minutes to ensure glue has dried before attaching new seat stay to the cable clip.
4. Position the new seat stay (E) on the seat interface. Clip on the new E-clip (F) using the needle nose pliers. (Fig 2)
5. Attach seat stay (E) to cable clip (G). (Fig 3)

⚠️ DEALER/TECHNICIAN WARNING

Attention dealers and qualified technicians, do not operate or service this device without first reading the owner's manual. If you do not understand the instructions and warnings in the owner's manual please contact the Quickie Technical Service Department before operating and/or servicing the Quickie device. Failure to do so may result in damage and/or injury.

Find more information and important warnings in the wheelchair owner's manual or at: www.SunriseMedical.com.

Sunrise Medical 2842 N. Business Park Ave Fresno, CA 93727 USA In Canada: (800) 263-3390