

! Please read these instructions carefully before beginning the assembly. Failure to understand and follow assembly instructions may result in injury to technician and/or end user and may void the warranty. If you have any questions call Sunrise Medical Technical Support at +1 (800) 333-4000.

Chairs



QX



Q2 Lite

Parts

99207004-001	M90-Plate Weldment non-Magnet Version	1
99207004-002	M90-Plate Weldment Magnet Version	1
99207007	Magnet Bracket Assy	1
000104109	FHCS ISO7046 M4x8 A2 ZNS NP	4
99207115	Axle sleeve 55,6 mm M20x1,5	2
99207102	Torque support plate	2
99207122	Torque support pin	2
103499-006	FHCS ISO10642 M5x16 8.8 DPS NP	2
104195	Nut jam alum. M20 x 1,5	2
128446	Washer flat 20mm ID BLK ZNC	10

Mount with magnet, on chair left-hand side

1

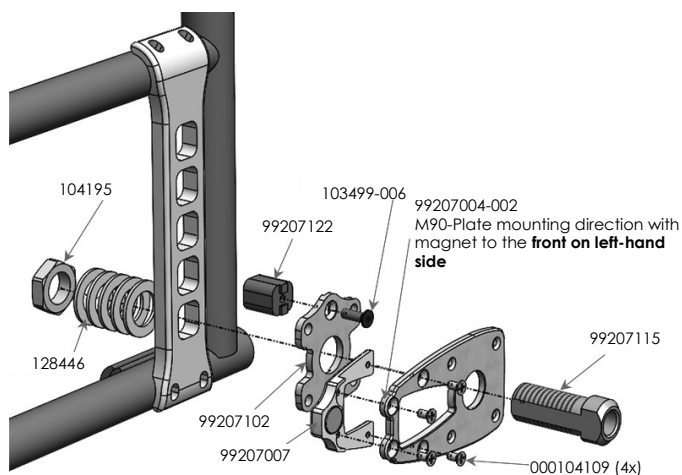

Mount without magnet, on chair right-hand side

2

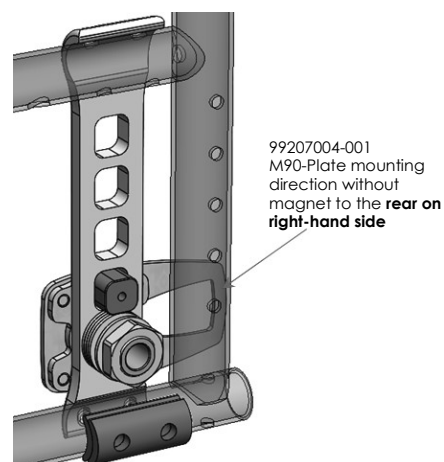

Kit mounted on chair

3

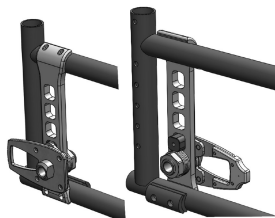

Kit per chair

4

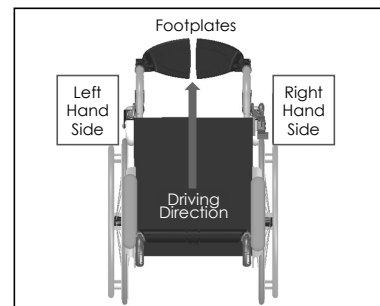
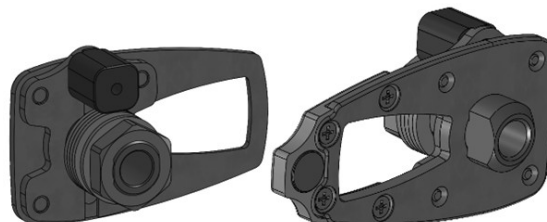

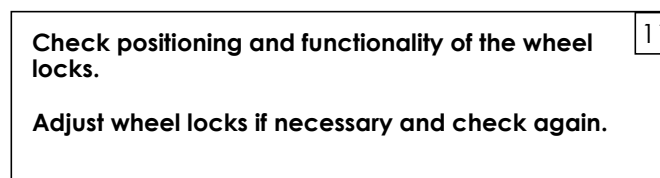
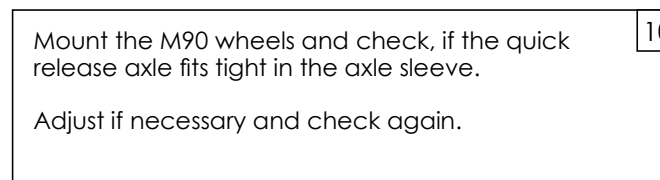
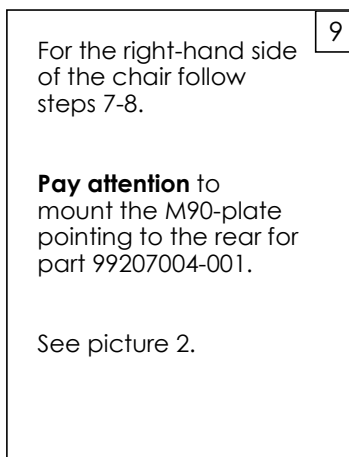
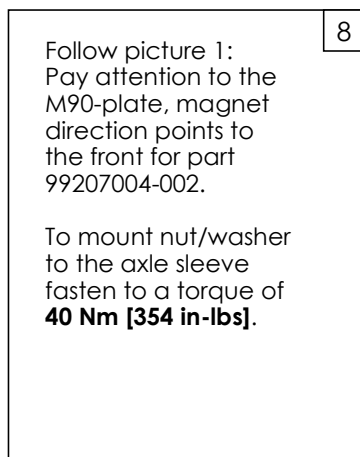
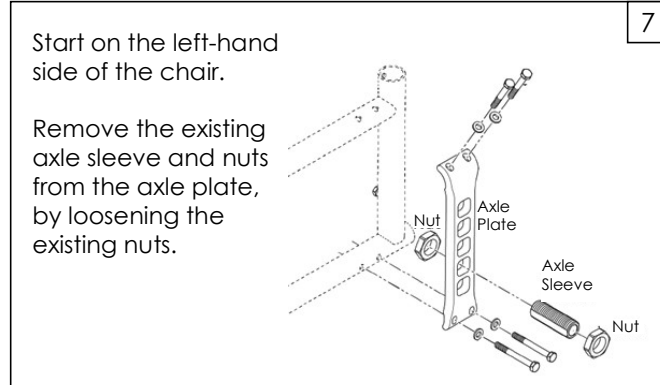
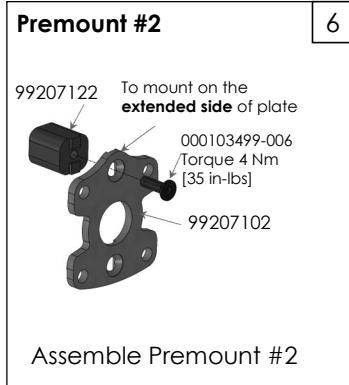
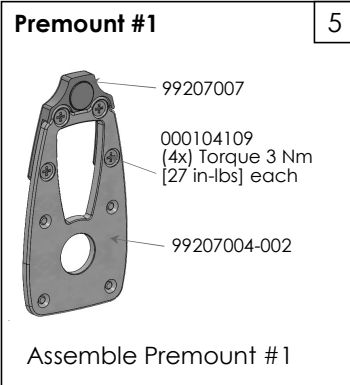

DEALER/TECHNICIAN WARNING

Attention dealers and qualified technicians, do not operate or service this device without first reading the owners manual. If you do not understand the instructions and warnings in the owners manual please contact the Sunrise Medical Technical Service Department before operating and/or servicing the Empulse device. Failure to do so may result in damage and/or injury.

Find more information and important warnings in the device owner's manual or at: www.SunriseMedical.com.