

INSTRUCTION SHEET

Converting between 0° or 3° Camber and 6° or 9° Camber Quickie GT

Tools Required:

- T25 Torx Wrench
- M4 Allen Wrench
- M5 Allen Wrench
- M6 Allen Wrench

**Note: Disregard this sheet if not converting camber angle.
(Please read and understand instructions before beginning installation)**

Before Beginning Conversion:

WARNING! Changing any components or settings of the rear axle assembly will change stability characteristics. Always use Anti-Tips or an attendant behind the chair until the rider becomes accustomed to the change.

- 1) For any given frame width, there are two possible Camber Tube widths that may be installed on the GT wheelchair as shown in Figure 3. For example: When using a 0° or 3° camber configuration, the Camber Tube width will measure about 1" less than the wheelchair width. When using 6° or 9° camber, the Camber Tube width will measure approx. the same as wheelchair width.
- 2) The Axle Plate Clamps can be installed biased inwards or outwards as shown in Figure 3, dependant on the camber chosen.
- 3) The Axle Plate (item 1) is always installed facing the same direction on the wheelchair as shown in Figure 1.

Remove:

- 1) Remove the Rear Wheels.
- 2) Detach the backrest assembly by removing the two Seatsplines (item 3) from the frame. Remove the two M6 Screws (item 11) and two M6 Screws and Nuts (items 4,5). Pull the Backrest assembly out of the frame (item 13).
- 3) Remove the Rear Strut (item 7) by sliding it off the back of the frame.
- 4) Loosen the four M8 Fasteners (item 12) on the Axle plate clamps (item 16). DO NOT loosen the four M6 Fasteners (item 6) (the smaller fasteners) also located on the Axle Plate Clamps.
- 5) Remove the two Camber Tube Clamp Screws (item 14). Note: These are the screws closest to the camber tube (item 8). The Camber Tube Clamp does not need to be removed from the Axle Plate. Slide the Camber Tube and Plugs (items 15 & 8) out from the assembly. Remove the Camber Plugs (item 15) from the Camber Tube (item 8) and set all aside.
- 6) Slide the Axle Plate Clamps (item 16) (with all attached parts) off of the back of the frame. Without changing front-to-rear orientation, place the left-hand Axle Plate/ Clamp Assembly onto the right-hand side of the Frame, and place the right-hand Axle Plate/ Clamp Assembly onto the left-hand side of the Frame. Ensure that the axle plates (item 1) are oriented as shown in Figure 1.

Install:

- 7) Install the new Camber Tube (item 8) into both Camber Tube Clamps (item 2).
- 8) Slide the Rear Strut (item 7) back onto the frame (item 13) and re-install the Backrest Assembly (item 3).
- 9) Replace and Tighten the two M6 Screws (item 11).
- 11) Replace and Tighten the two M6 Screws and Nuts (items 4,5).
- 12) Slide the two Axle Plate Clamps (item 16) along the Frame (item 13) to the desired CG Location, ensuring they're symmetrically aligned with the frame (item 13). View chair from the rear and check that both Axle Plates are aligned vertical, and symmetric to each another.
- 13) Tighten the four M8 Fasteners (item 12) to 144 in-lbs.
- 14) Slide in the New Camber Plugs (item 15).
- 15) Refer to Owner's Manual for toe in/out, CG and rear wheel gap adjustment.

WARNING! Changing any components or settings of the rear axle assembly will change stability characteristics. Always use Anti-Tips or an attendant behind the chair until the rider becomes accustomed to the change.

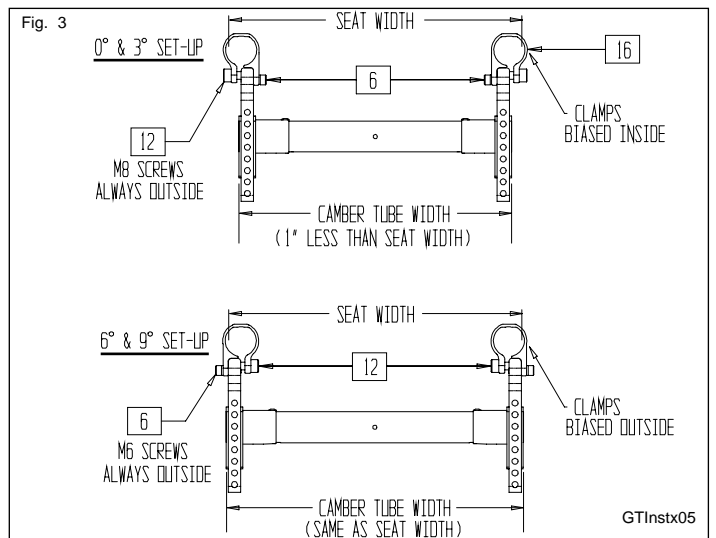
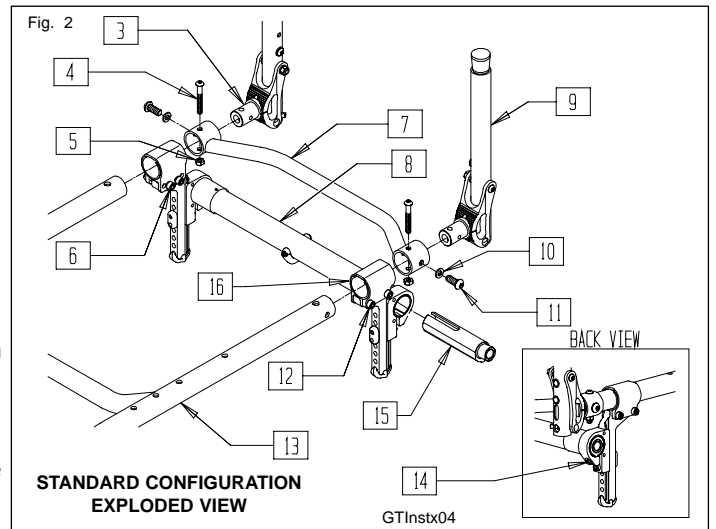
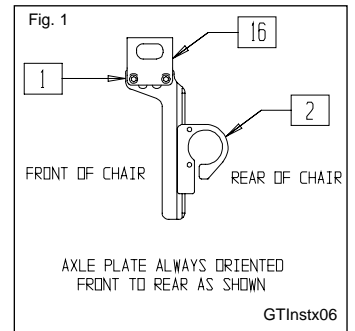

FOR DEALER USE Installed by: _____ Serial #: _____ Date: _____ (retain as record of installation)