



QUICKIE M6 HEAVY DUTY FORK INSTRUCTION SHEET



Please read these instructions carefully before beginning the assembly. Failure to understand and follow assembly instructions may result in injury to technician and/or end user and may void the warranty. If you have any questions call Sunrise Medical Technical Support at +1 (800) 333-4000.

Parts included for 8" fork assembly:

- | | |
|--|---------------------------------|
| 1. 2 x 134064 heavy duty fork assembly | 4. 2x 106939 5/16-24 nylock nut |
| 2. 2x 222253 5/16-24 x 3-1/4 hex screw | 5. 8x 263100 5/16 washers |
| 3. 4x 481113 bearing spacer | |

Required tools:

1. 3/16" hex key
2. 5/16" socket wrench
3. 5/16" crescent wrench

Parts included for 5" fork assembly:

- | | |
|---|---------------------------------|
| 1. 2 x 251629 5" heavy duty fork assembly | 4. 2x 106939 5/16-24 nylock nut |
| 2. 2x 106987 5/16-24 x 2-1/2 hex screw | 5. 8x 263100 5/16 washers |

The following assembly instructions are for replacing the Fork on the Quickie M6 with Heavy Duty Fork.

A. REMOVE EXISTING FORK ASSEMBLY:

1. Remove hardware (Fig 1):
 - a. Using 3/16" hex key, remove 2 x 5/16-18 (A) button head screws from latch studs. Slide out old fork assembly. Set aside screws and latch studs for reassembly.
 - b. Remove 5/16-24 (B) hex head screws and nylock nuts from caster wheels. Discard hardware and forks, set caster wheels aside for reassembly.

B. MOUNT NEW 8" HD FORK ASSEMBLY:

2. Assemble new fork (Fig 2):
 - a. Assemble with saved caster wheels from step 1B using included hardware. Reassemble hardware as shown (C), see included parts list. Tighten securely.
 - b. Slide new fork into frame. Reassemble with button head screws and latch studs saved from step 1A. Tighten securely. Shown as D in Fig 2.

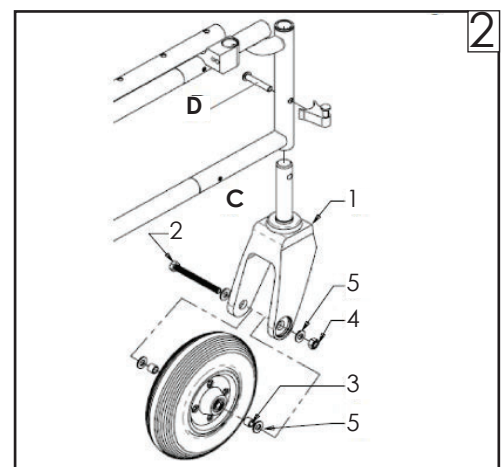
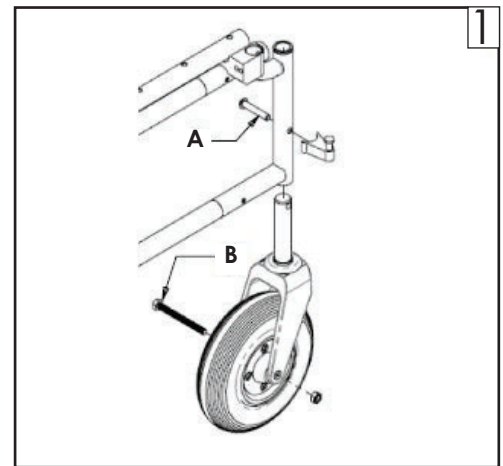

Sunrise Medical 2842 N. Business Park Ave Fresno, CA 93727 USA



Customer service: +1(800) 333-4000
or visit www.SunriseMedical.com

© 2020 Sunrise Medical (US) LLC
06/2020 MK-100206 Rev. C
Page 1 of 2



QUICKIE M6 HEAVY DUTY FORK INSTRUCTION SHEET



Please read these instructions carefully before beginning the assembly. Failure to understand and follow assembly instructions may result in injury to technician and/or end user and may void the warranty. If you have any questions call Sunrise Medical Technical Support at +1 (800) 333-4000.

B. MOUNT NEW 5" HD FORK ASSEMBLY:

3. Assemble new fork (Fig 3):

- a. Assemble with saved caster wheels from step 1B using included hardware. Reassemble hardware as shown (C), see included parts list. Tighten securely.
- b. Slide new fork into frame. Reassemble with button head screws and latch studs saved from step 1A. Tighten securely. Shown as D in Fig 3.

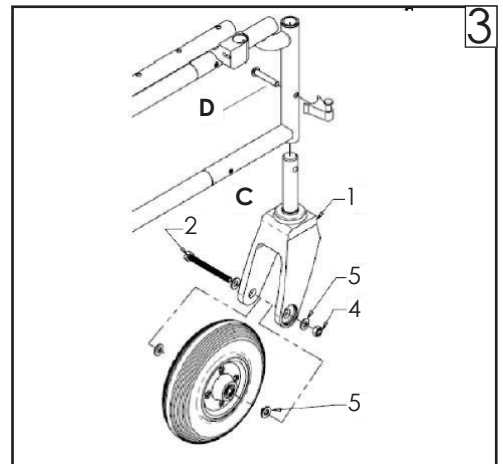

DEALER/TECHNICIAN WARNING

Attention dealers and qualified technicians, do not operate or service this device without first reading the owners manual. If you do not understand the instructions and warnings in the owners manual please contact the Quickie Technical Service Department before operating and/or servicing the Quickie device. Failure to do so may result in damage and/or injury.

Find more information and important warnings see the wheelchair owner's manual or at: www.Sunrisemedical.com.

Sunrise Medical 2842 N. Business Park Ave Fresno, CA 93727 USA



**Customer service: +1 (800) 333-4000
or visit www.SunriseMedical.com**

© 2020 Sunrise Medical (US) LLC
06/2020 MK-100206 Rev. C
Page 2 of 2