

Quickie IRIS User Wheel Lock Setup



- No-Go
- Setup Not Available
- *Forward
- Rearward
- Short Rearward

Long Push to Lock Wheel Lock POS

Rear Wheel Size	Roller Pos	Axle Pos							
		12	13	14	15	16	17	18	
12	1	2	2	2	1	1	1	1	
	2		3	2	2	2	1	1	
	3	1*	1*	3	2	2	2	1	
	4		1*	1*	3	2	2	2	
	5			1*	1*	3	2	2	
	6				1*	3	2	2	
16	1	1*	3	2	2	1	1	1	
	2	1*	1*	3	2	2	1	1	
	3	1*	1*	1*	3	2	1	1	
	4		1*	1*	1*	3	2	2	
	5			1*	1*	1*	3	2	
	6				2*	1*	1*	3	
20	1	2*	2*	1*	3	3	2	1	
	2	2*	2*	1*	1*	3	2	2	
	3	3*	2*	2*	1*	1*	3	2	
	4		3*	3*	2*	1*	1*	3	
	5			3*	2*	2*	1*	1*	
	6				3*	2*	2*	2*	
22	1	2*	2*	1*	1*	3	2	2	
	2	3*	2*	2*	1*	1*	3	2	
	3	3*	3*	2*	2*	1*	1*	3	
	4		3*	3*	2*	2*	1*	3	
	5			3*	3*	2*	2*	1*	
	6				3*	3*	2*	2*	
24	1	3*	2*	2*	1*	1*	3	2	
	2	3*	2*	2*	2*	1*	1*	3	
	3	3*	3*	3*	2*	2*	1*	1*	
	4		3*	3*	3*	2*	2*	1*	
	5			3*	3*	2*	2*	2*	
	6				3*	3*	3*	2*	

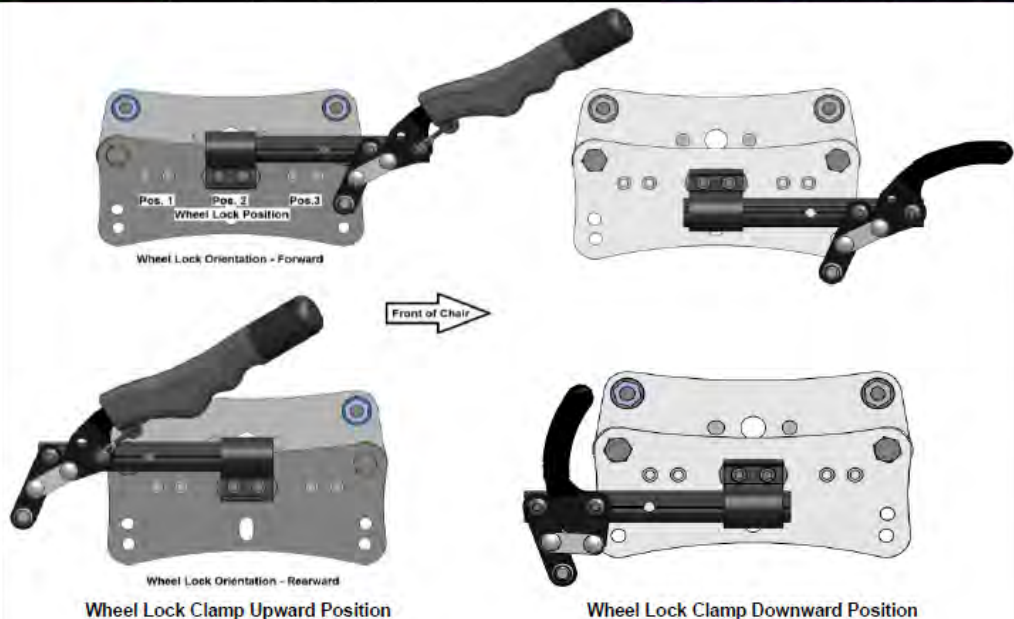

- Notes:**
- * When Axle Plate Orientation is in 1-4 (ENG910), install wheel lock clamp in upward position
 - * When Axle Plate Orientation is in 5-8 (ENG910), install wheel lock clamp in downward position

Quickie IRIS User Wheel Lock Setup



- No-Go
- Setup Not Available
- *Forward
- Rearward
- Short Rearward

Short Rearward Push to Lock Wheel Lock POS

Rear Wheel Size		Roller Pos	Axle Pos						
			12	13	14	15	16	17	18
12		1							
		2	3						
		3							
		4							
		5							
		6							
		6							
16		Roller Pos	Axle Pos						
			12	13	14	15	16	17	18
		1							
		2							
		3							
		4							
		5							
6									
20		Roller Pos	Axle Pos						
			12	13	14	15	16	17	18
		1							
		2							
		3							
		4							
		5							
6									
22		Roller Pos	Axle Pos						
			12	13	14	15	16	17	18
		1							
		2							
		3							
		4							
		5							
6									
24		Roller Pos	Axle Pos						
			12	13	14	15	16	17	18
		1							
		2							
		3							
		4							
		5							
6									

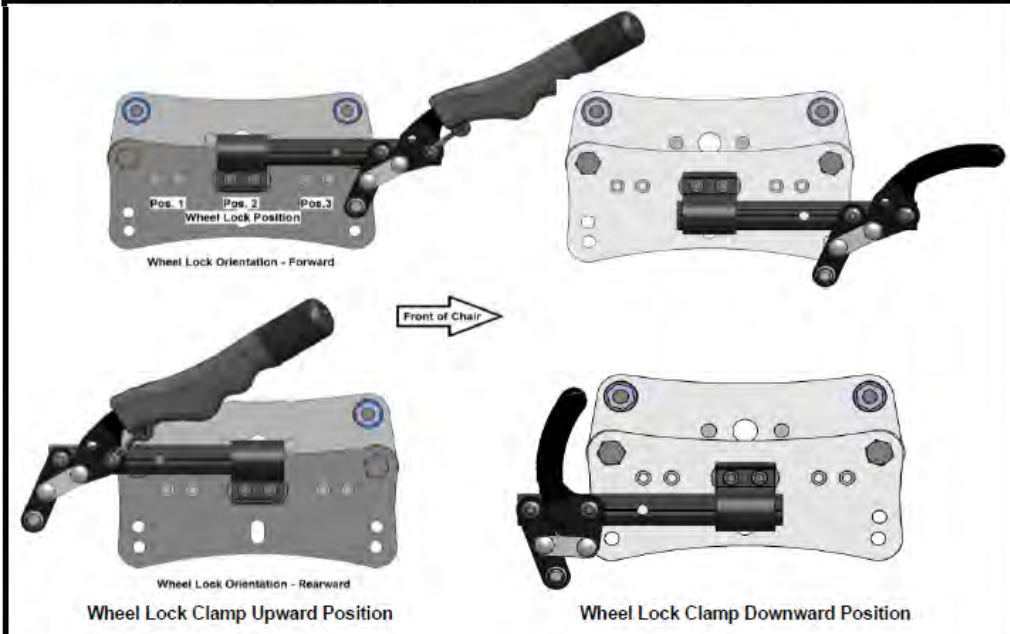

- Notes:**
- * When Axle Plate Orientation is in 1-4 (ENG910), install wheel lock clamp in upward position
 - * When Axle Plate Orientation is in 5-8 (ENG910), install wheel lock clamp in downward position